

Expression of Interest

Lyn Rice Architects [LRA], enthusiastically submits this Expression of Interest for the design of a new building for the Faculty of Architecture, Building and Planning (ABP) of the University of Melbourne. This project represents a remarkable architectural, educational, and cultural opportunity, and aligns perfectly with our firm's passions and expertise.

We take real pleasure in rigorously working the constraints of practice to our projects' architectural advantage, even while we embrace critical thinking and are inspired by utopian ideals. We consider economic, political, bureaucratic, physical, and programmatic requirements as essential to the creative process, providing a generative resistance that encourages design innovation. Rather than imposing solutions from an outside logic, from the top down, or relying solely on creative genius - we work to understand the unique opportunities that are encoded within a given project brief. We ask, how can we prompt solutions to emerge – to percolate up from these complex requirements and mix with our desires, our aesthetic sensibility, and our critical perspective? The team works in an iterative process that challenges architectural and programmatic norms, temporarily accepting partial or even seemingly failed solutions. We organize these possibilities in issue-based menus that, when examined as a whole, provide us with new insights into each project, and with a fertile platform on which to work.

With range of projects cultural, civic and private projects including LRA's highly relevant, 2009 National AIA Honor Award-winning, Sheila C. Johnson Design Center which establishes a new 32,800sf multi-program campus nexus for Parsons The New School for Design, we have an exceptional breadth and depth of experience. We work effectively with a wide range of stakeholders, university constituents, and the public to produce memorable, innovative, and sustainable places for learning.

Our team envisions the new Faculty of Architecture, Building and Planning building actively connecting with its urban-campus context and engaging/energizing the surrounding community. We see new architectural, landscape, and graphic interventions coalescing to create a strong, vibrant, contemporary identity for the School, while respecting the character and integrity of its surrounding environment.

LYN RICE ARCHITECTS

Expresion of Interest
Faculty of Architecture, Building and Planning
The University of Melbourne
May 01, 2009

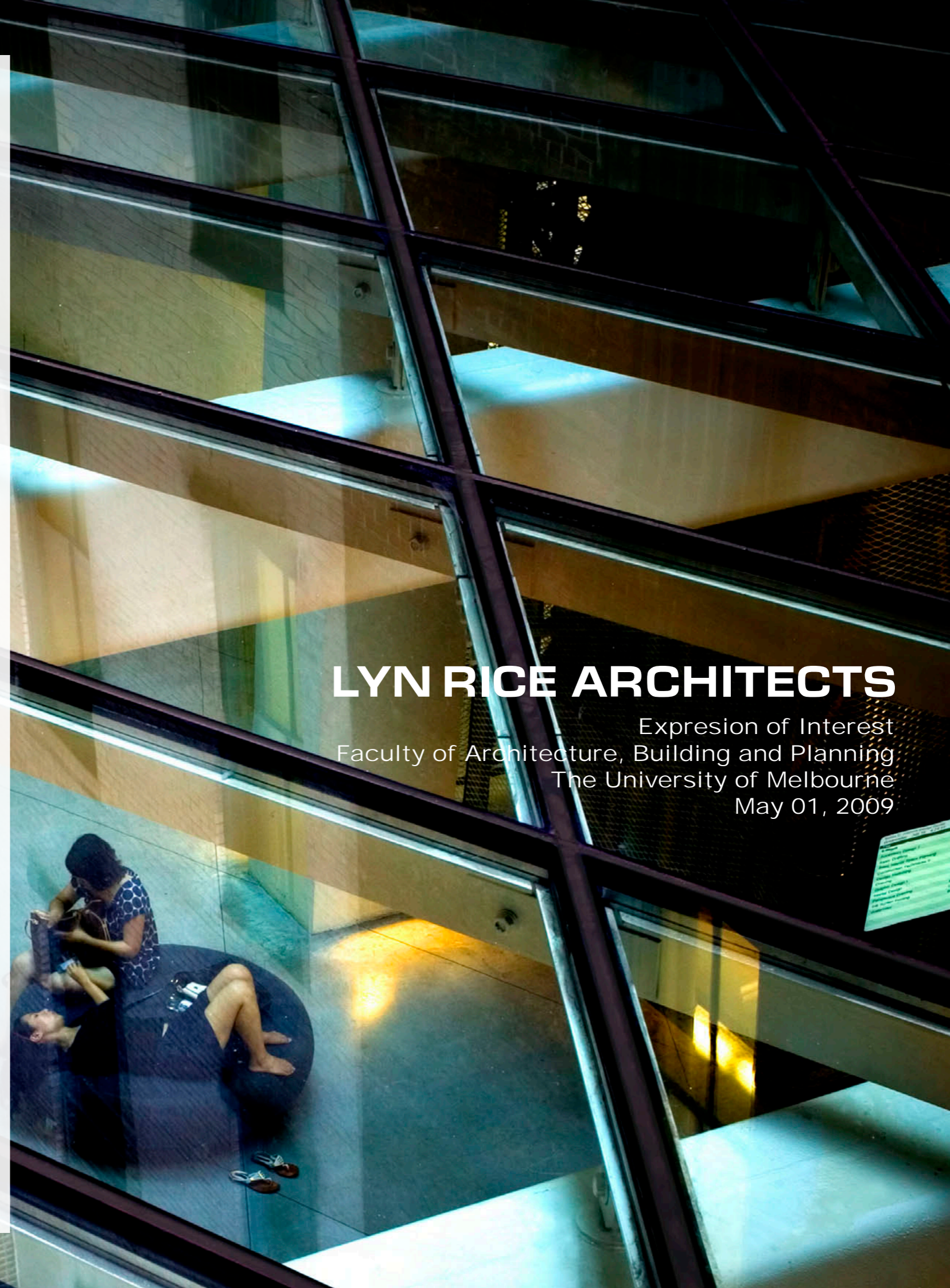

How We Work

Lyn Rice Architects has planned and designed facilities for some of North America's premier educational and arts institutions. In these efforts, we have developed and employed an expertise in envisioning how these organizations could operate by using an open-ended conceptual process. This allows us to work closely with our clients to seek optimal architectural solutions that take advantage of the opportunities presented by the program, site, and context without resorting to the conventions of type. The design of the new building for Faculty of Architecture, Building and Planning (ABP) presents an exciting moment for just this kind of innovation.

USE ALL MEANS + MEDIA TO COMMUNICATE AND EXPLORE

We will work at multiple scales simultaneously – from the site to the detail so that all components work efficiently together toward the same ends. We produce a range of schemes that explore the implications of multiple site, programmatic, MEP, structural and architectural strategies. Using digital diagramming, modeling, animation, rendering, physical models and mockups from the beginning of the project, we will ensure that we and all stakeholders understand the issues at stake and the implications of each potential solution completely.

EMBRACE CONSTRAINT (INCLUDING THE BUDGET)

We will listen and learn about the Faculty of Architecture, Building and Planning and its programs. We will efficiently synthesize this information, and will work within the budget to open up the potential [the performative aspects] of the program in relation to the pragmatic requirements of the project to maximize spatial and visual impact. We will produce multiple architectural solutions – a menu board of choices that will individually unpack issues of image, mission, access, schedule, security, expansion, and site – using an iterative process that embraces practical constraints and puts them to use as generative devices. Throughout the design process, we will maintain up-to-date costing which allows us to evaluate costs with the client group concurrently with design issues. This provides a constant tracking of the project cost, which is confirmed with each formal estimate, allowing us to respond to budget issues more effectively.

INNOVATION THROUGH COLLABORATION

The new building for the ABP is an ideal fit with the LRA's extensive experience in creating architecture which supports learning and creates shared spaces that are both inspiring and functional. LRA's carefully selected a group of consultants firms are committed to a seamless collaboration which seeks out the most productive approaches, whatever their source. The team will deliver design excellence and architectural innovation by maintaining dedicated staff for the project and ensuring that all key team members are available in Melbourne for design workshop and presentations.

Key Principles

We understand the complexity of establishing a vision for the Faculty of Architecture, Building and Planning, and believe that the potential of the project will take shape through our discussion of the School's goals and a careful, collaborative exploration of the project's possibilities. Still, we do see a few key principles that are likely to be a part of the design process and important in bringing this project to fruition.

CONNECTIONS

As both the home to its academic programs and a center of architectural culture, it is critical that the expanded buildings' relationship to its physical, institutional, and social context be optimized. By doing so, we will be able to energize the building and support its academic mission by connecting spaces both functionally and aesthetically. In addition, the building should respond to its role in the larger community along with the University as a whole, providing a legible identity and entrance that engages the public and provides clear examples of innovative and sustainable design.

OPPORTUNISM

Rather than approaching the project seeking a singular ideal form or organization, we believe that by identifying the specific parameters of a project and by optimizing the relationships between internal and external elements, a vibrant, yet highly calibrated and uniquely appropriate facility can be achieved. Through a rigorous process of documentation and analysis of program and site, it is possible to provide a stable, accurate, and generative platform upon which unexpected programmatic, infrastructural, and spatial opportunities will be revealed. In addition, by opportunistically borrowing from models outside of the traditional conventions of collegiate architecture (whether from retail, cultural, or other precedents), a freshly activated facility that may be more radically well suited to the needs of the Faculty of Architecture, Building and Planning may emerge.

AMPLIFICATION

As the programming and design of the expanded building progresses, we believe that it is important to keep in mind that the cumulative effect of the completed facility is more than its constituent parts. Careful planning can ensure that each part of the facility contributes to the success of the building and the campus as a whole. Likewise, the new addition should respect the history of the existing building, not by mimicking it, but rather by providing a contemporary complement which amplifies the history of the site while fostering the new vibrant architectural elements both inside and outside the existing envelope.

FLEXIBILITY

Any institution or organization has to be able to accommodate change, and even to foster it. The physical space of the Faculty of Architecture, Building and Planning, while designed to accommodate today's conception of how it should operate, must be nimble enough to accommodate change throughout the years. Rather than building in a way which closes down options, we believe it is possible to operate as planners, helping to define a range of possibilities of how spaces can be used, while maintaining a unique, vibrant, and efficient character integrally tied to the daily life of the school.

SUSTAINABILITY

The existing Faculty of Architecture, Building and Planning's inherent environmental flexibility should be embraced and built upon to develop a unique and opportunistic environmental response. Through the strategic re-use of existing infrastructure, enhancing and controlling daylighting and ventilation, as well as by organizing programmatic adjacencies to become co-dependent catalysts for new systems and technologies, we will mine the project's nascent potential for economic and environmental sustainability. Having incorporated current issues of sustainable design in multiple projects at varying scales and complexity, the Lyn Rice Architects has a clear understanding of the goals, challenges as well as potential opportunities to be found within an open-ended approach to design.

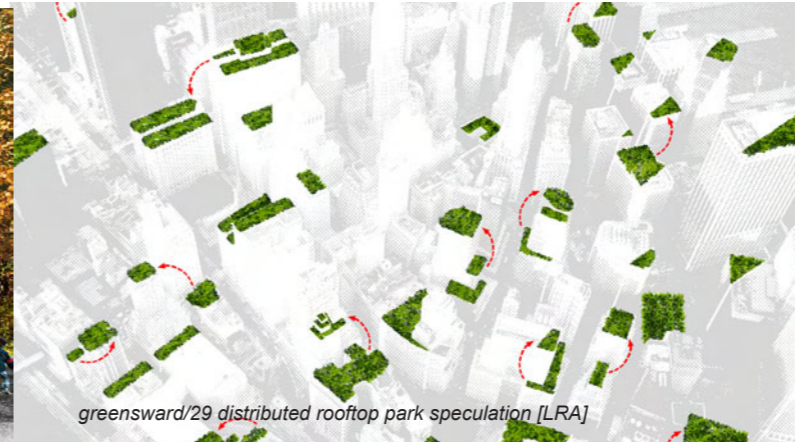

Office Profile

Lyn Rice Architects [LRA] is an award-winning, New York based architectural platform for a range of building, planning, art and cultural research projects. The practice seeks to engage the public with contemporary built works that emerge from fresh programmatic and formal speculations, and that integrate new construction techniques and materials.

LRA closely examines the performative aspects of program for their spatial and formal potentials in an iterative process that embraces practical constraint. LRA generates multiple architectural solutions which accumulate to form a menu of possibilities that, through a client-oriented process of open exchange, allow pragmatic and conceptual issues to mix, encouraging unexpected, innovative results.

Past LRA work ranges from large scale museum, educational, office, retail, and planning projects to public and privately commissioned conceptual installations, exhibition design, graphic design, curatorial, and branding projects. LRA connects with artists, designers, programmers, curators, and innovators, merging diverse working methods to create architectural projects without prescribed limits. Former collaborators include artists Robert Irwin, Liam Gillick, Miles Coolidge, Peter Kogler, Ben Rubin, and architects Diller+Scofidio.

LRA has recently completed construction on the 2009 AIA National Honor Award, 2008 AIA New York State Award of Excellence and 2008 AIA NY/Boston Society of Architects Honor Award-winning *Sheila C. Johnson Design Center* at Parsons The New School for Design, a 32,800 sf transformation of street level galleries, auditorium, archive, orientation, and meeting spaces in New York's Greenwich Village. Other current and recent projects include the design of *Carriage Houses* on Staten Island and a planning+design project for the Long Island City Cultural Alliance (both part of NYC's Design Excellence Program), a new university *Welcome Center* for The New School, a 10,000 sf Inner-Mongolian Villa (part of Ai Weiwei and Herzog & DeMeuron's *Ordos 100 Master Plan*), offices for The Joan Mitchell Foundation in New York's Chelsea Arts Tower, a vision/strategic plan and multiple exhibition projects for the Krannert Art Museum at the University of Illinois, and an exhibition concept+design project for the National Building Museum in Washington DC. Lyn Rice was formerly a principal of OpenOffice Arts + Architecture Collaborative, where he was a partner-in-charge of the 2006 AIA NY Design Award-winning, *Dia:Beacon*, in collaboration with artist Robert Irwin, and *80 Arts: The James E. Davis Arts Building* for the BAM LDC.

Member, American Institute of Architects (AIA); *Member*, United States Green Building Council USGBC (LEED certifiers); *Member + Exhibition Committee*, The Architectural League of New York; *Contributor/Member*, The Van Alen Institute, New York; *Contributor/Member*, Storefront for Art and Architecture, New York; *Member*, The Society of American Registered Architects; *Former Fellow*, Institute for Urban Design, New York

WWW.LRANY.COM

Design Team

Lyn Rice Architects is open to many team configurations - we are easy to work with. While it is certain that a number of consultants will be necessary for the design of the New Students' Centre Building, we have initially included Buro Happold Consulting Engineers (BH) on our team because of the wide variety of integrated services they are able to provide, along with their office locations in London and New York. We have worked extensively with BH in the past and have found that their interdisciplinary capabilities allow them to provide our clients with timely service and the highest levels of expertise. BH will be responsible for structural engineering, MEP engineering, and sustainability consulting. We will draw upon our strong relationships with other consultants as necessary based on the specific parameters of the project, as well as engaging the services of consultants in the UK. In the past, we have successfully led teams that included: Buro Happold (S/MEP), Arup (S/MEP), Langan Engineering (Civil/Geotech), Front (Glazing), Tillotson Design Associates (Lighting), Richard Shaver Architectural Lighting, Cerami Associates (Audiovisual/Acoustics), SCAPE (Landscape), along with many other.

BURO HAPPOLD CONSULTING ENGINEERS

Buro Happold Consulting Engineers is a world class integrated multi-disciplinary company able to offer a complete range of disciplines dealing with the built environment. Critical to the firm's success, and significant in its differentiation from other engineering practices, is a commitment to project-wide, multi-discipline, technical integration. From this commitment, Buro Happold has been able to help its clients to far exceed initial goals whilst maintaining schedule and budget.

Engaging local communities and ensuring their meaningful and on going participation is also a crucial part of Buro Happold's philosophy. The firm seeks to formulate strategies that are both 'bottom up' and 'top down', fostering inspired leadership. They develop carefully tailored and practical solutions for their clients, based on best practice and promoting urban quality, coherence and local distinctiveness. Founded in the UK, where it has seven offices, Buro Happold practices from a world wide network of 22 offices located in 12 countries.

Relevant Experience

Lyn Rice Architects has been involved in the conceptualization, design, and implementation of a number of important academic and cultural facilities with a wide variety of schedule, budget, and physical contexts. These projects have required a keen attention to the needs of the client and the specificities of program and site in order to avoid resorting to conventions of type, but rather to find the grounds for innovation within the very constraints of the project. We have identified key projects which we believe demonstrate our expertise in creating environments with complex and varied programs which seek an engagement with the social, cultural, and physical context. Each of these projects pays attention to the programmatic, spatial, and cultural complexities involved, producing spaces that are not only optimized for efficiency, but memorable, generous, and unexpected.

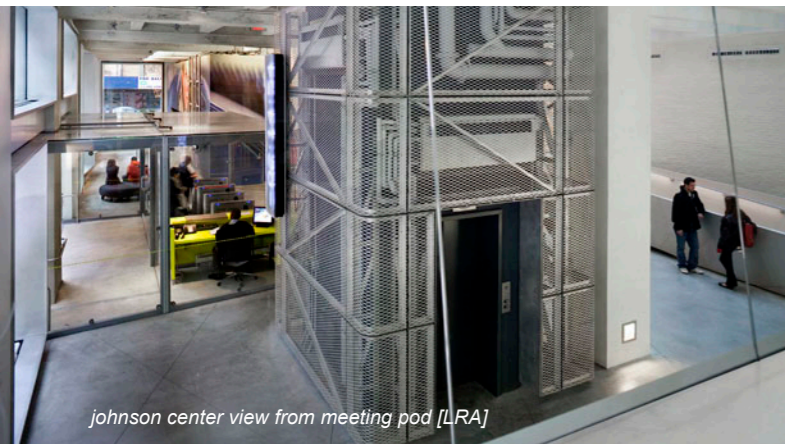

johnson center view from meeting pod [LRA]



joan mitchell foundation offices [LRA]



parsons academic tower [LRA]



LANDSCAPES [LRA]

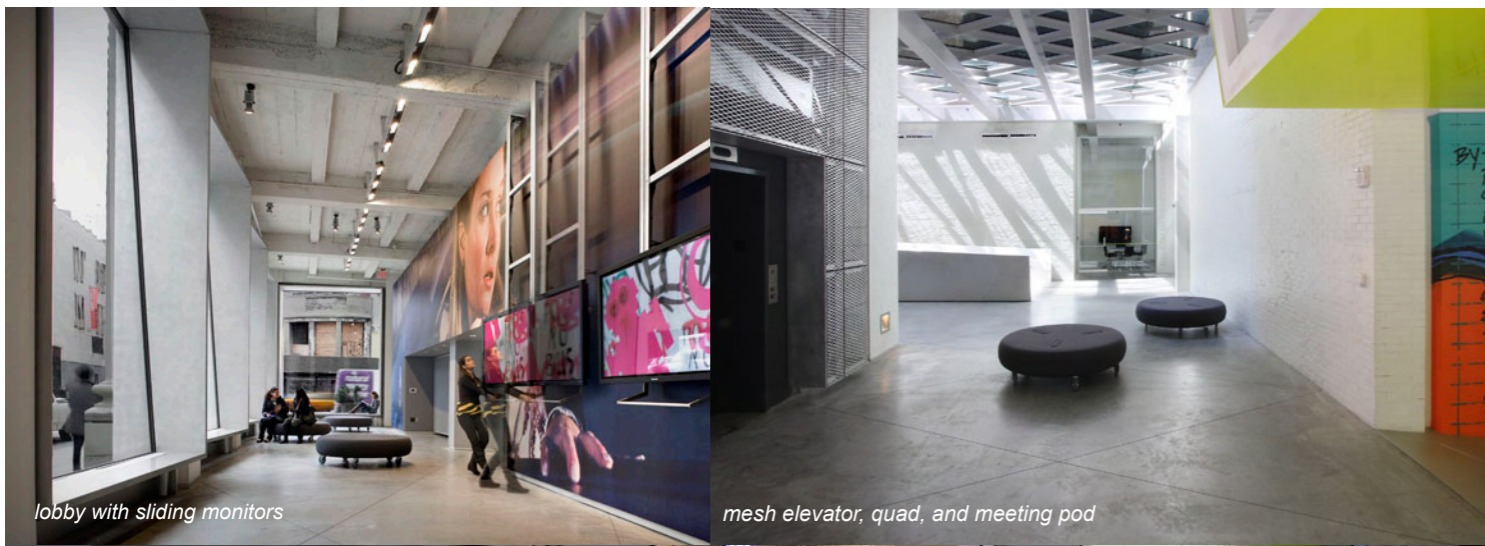

lobby with sliding monitors

mesh elevator, quad, and meeting pod

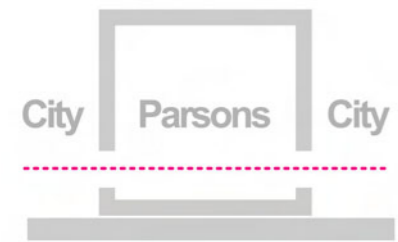

City Parsons City

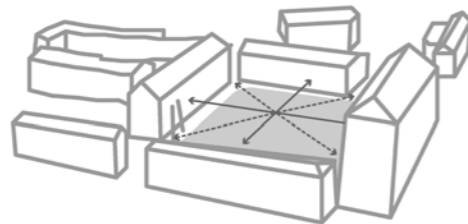

PLANNED QUAD
quad result of campus master plan

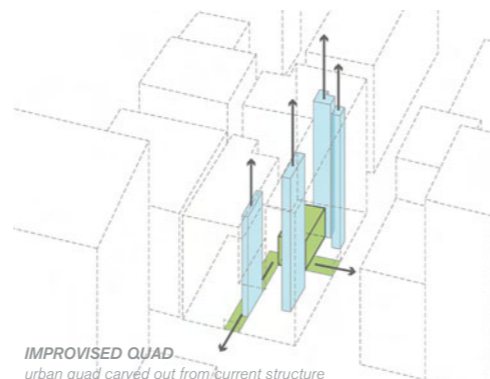

IMPROVED QUAD
urban quad carved out from current structure



glazed roof urban quad

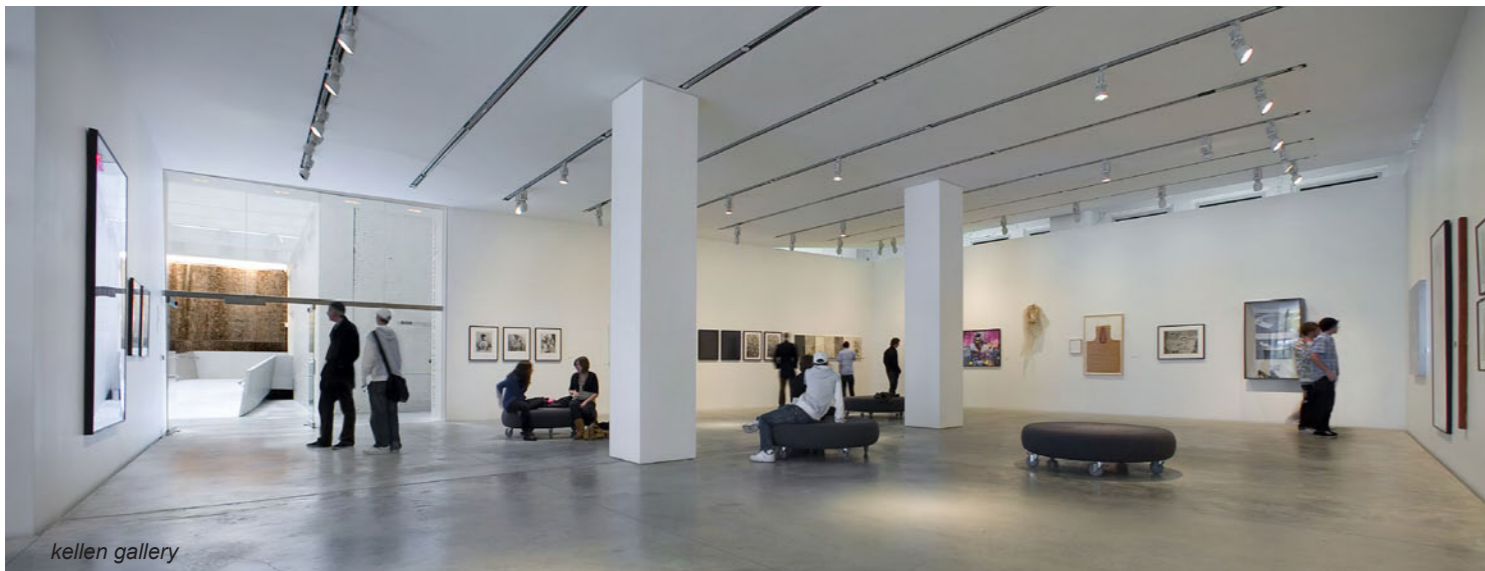

kellen gallery

SHEILA C. JOHNSON DESIGN CENTER Parsons The New School for Design, New York, NY

The Sheila C. Johnson Design Center unites the four historic [1918-1919] buildings that comprise the campus of Parsons The New School for Design and organizes a range of shared spaces around a new urban quad. New entries on Fifth Avenue and on West 13th Street connect via the quad to provide access to the 32,800-square-foot center's new auditorium, galleries, archives center, student critique area, orientation center, and meeting rooms.

Stripped to expose its substantial concrete and steel structure, the buildings' character provides a raw and varied industrial context for new, more refined architectural interventions. Student work is made visible to the street through a new transparent façade of deep-set windows that wrap 250 feet around the complex's perimeter. Made possible through the generous gift and vision of Sheila C. Johnson, the Center newly links program spaces that recognize the urban context of the institution, reflect The New School's commitment to the new, and place on view to the street the innovative work being produced at the University.

- Architect** Lyn Rice Architects
- Client** The New School
- Design Team** Lyn Rice, Astrid Lipka, Kimberlae Saul, Kai Hotson, Karl Larson, Anne Schiffmann
- Consultants** Buro Happold
Front Inc.
Langan Engineering
Richard Shaver Architectural Lighting
Cerami & Associates
Construction Specifications, Inc.
JAM Consultants
Van Deusen & Associates
- Size** 32,800 sf
- Budget** USD \$20 million
- Construction** completed 2008



view from fifth avenue sidewalk with monitors

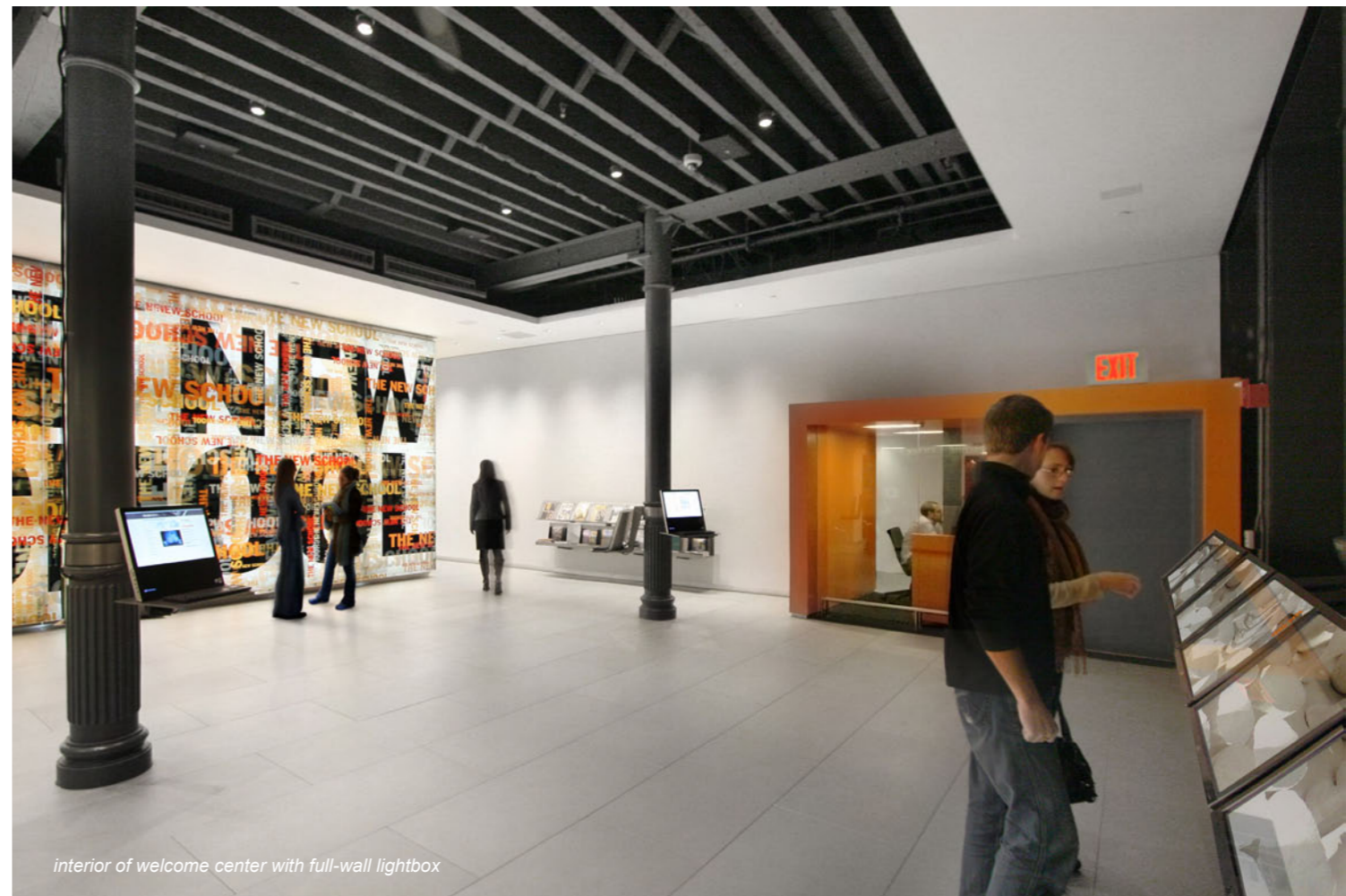

interior of welcome center with full-wall lightbox

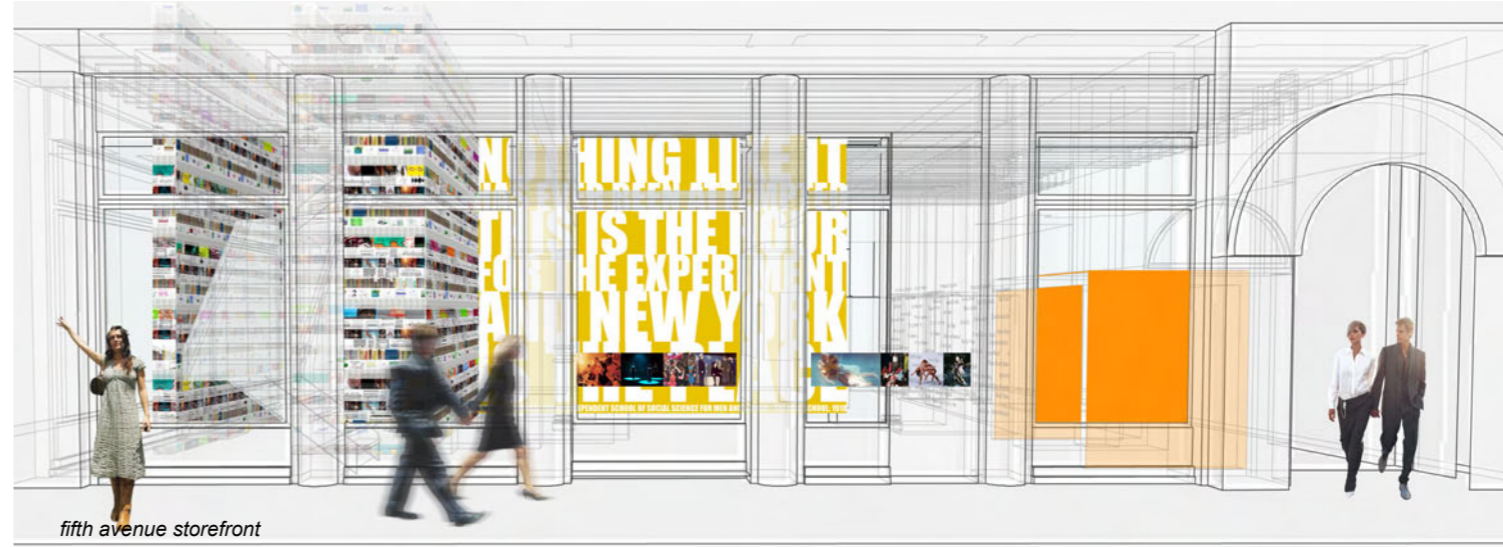

fifth avenue storefront

UNIVERSITY WELCOME CENTER

The New School, New York, NY

In the street level design of a new university welcome and information center serving students and visitors to The New School's New York City campus, the early 20th century lobby space (of the original Citibank branch bank) is stripped bare to expose its original structure. An existing stair is sandwiched between two new walls which also house the reception desk. Attached to the building structure are steel armatures which display brochures and support interactive computer terminals as well as a bank of monitors facing both the interior and the street.

A full-wall lightbox frames the space from west (back) side with a digital transparency that announces the presence of The New School to visitors, prospective students, and the city at large. This lightbox is of an urban scale to respond to the street, but also serves as the source of illumination for the lobby. The space is flanked on the north by a new entry and security threshold.

| | |
|---------------------|--|
| Client | The New School |
| Design Team | Lyn Rice, Astrid Lipka, Ivan Chabra, Anne Schiffmann, Steven Chen |
| Consultants | Cooper, Robertson & Partners Robert Silman Associates Herbert Kunstadt Associates Design 2147 |
| Size | 1,700 sf |
| Cost | USD \$700,000 |
| Construction | completed February 2009 |



fifth avenue sidewalk



john chamberlain gallery looking east

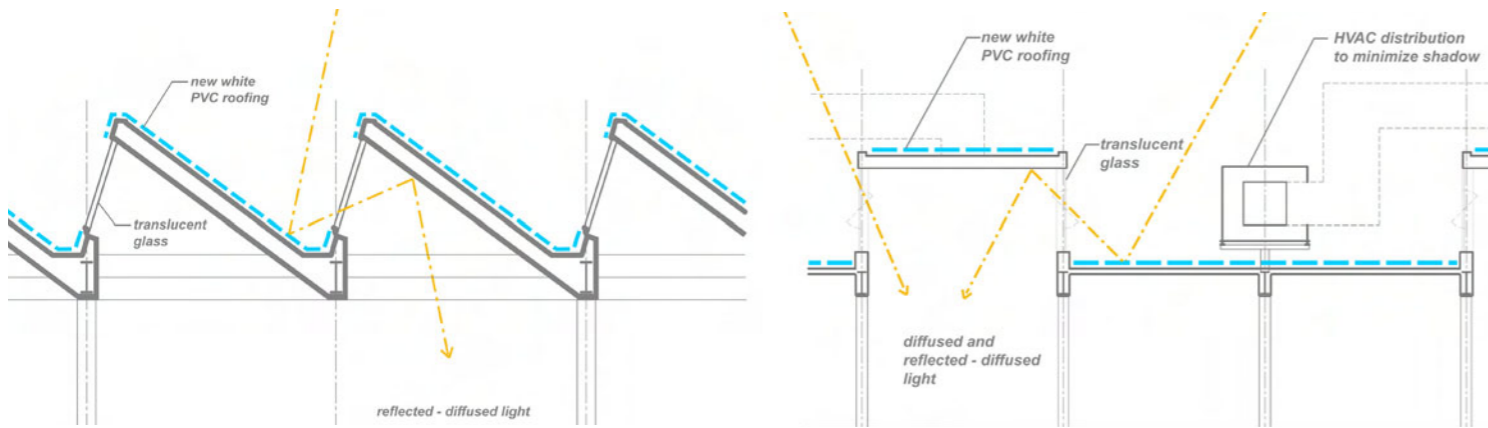

daylighting diagrams



aerial view with hudson river

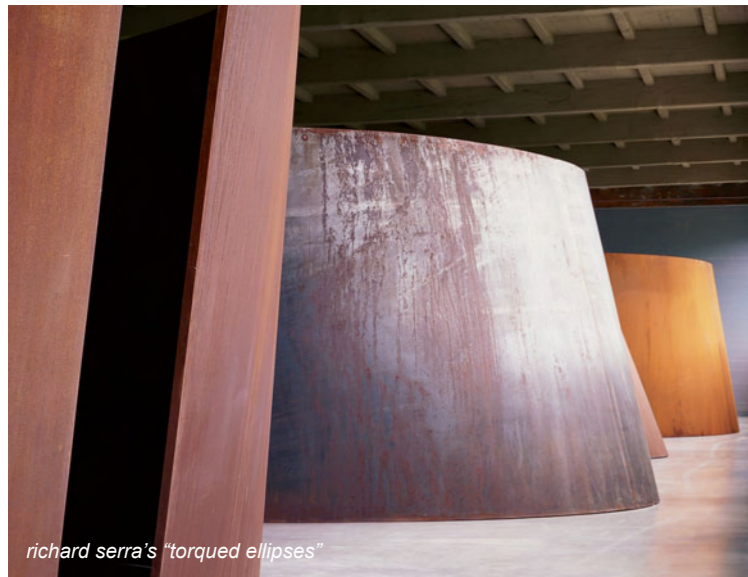

richard serra's "torqued ellipses"

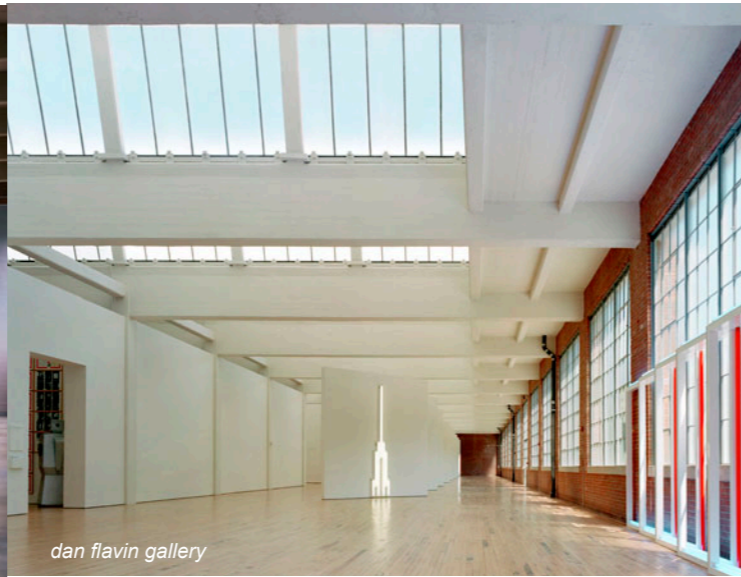

dan flavin gallery

DIA:BEACON Beacon, NY

Client Dia Art Foundation
Design Team Lyn Rice (architect-of-record), Alan Koch, Galia Solomonoff, Linda Taalman, Jay Hindmarch, Astrid Lipka
Consultants Robert Irwin, Ross Dalland, P.E., Ove Arup & Partners, T.M. Depuy Civil Engineering, Construction Specifications, Inc., Glezen-Fisher, Jeffrey Shrimpton
Size 292,000 sf
Budget USD \$25 million
Construction completed 2003

Winner of the 2006 AIA/NY Merit Award for Architecture, Dia:Beacon is the conversion of a 292,000 sf Nabisco box-factory, situated along the Hudson River, into a museum for Dia Art Foundation's renowned art collection. The primary mission of the project was to maximize the spatial strength of sculpture, painting, landscape and architecture, by optimizing natural light, and minimizing the use of material resources, creating a restrained architecture that firmly embraces the artworks and visitors without overwhelming either.

The 1929 structure, with its extensive skylight systems and industrial character, houses permanent galleries for large-scale artworks, as well as a bookstore, café, educational-media facilities, offices, and gardens. The team converted the old Nabisco administrative wing to non-gallery functions, while the large open areas of the factory floor were used as gallery spaces and darker cellar spaces were programmed for art storage. With Irwin, the design team developed new site circulation, parking and planting for the grounds surrounding the museum.